

PRODUCT CATALOGUE

产品目录

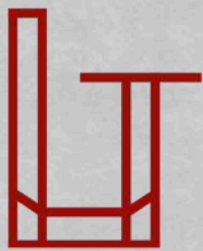

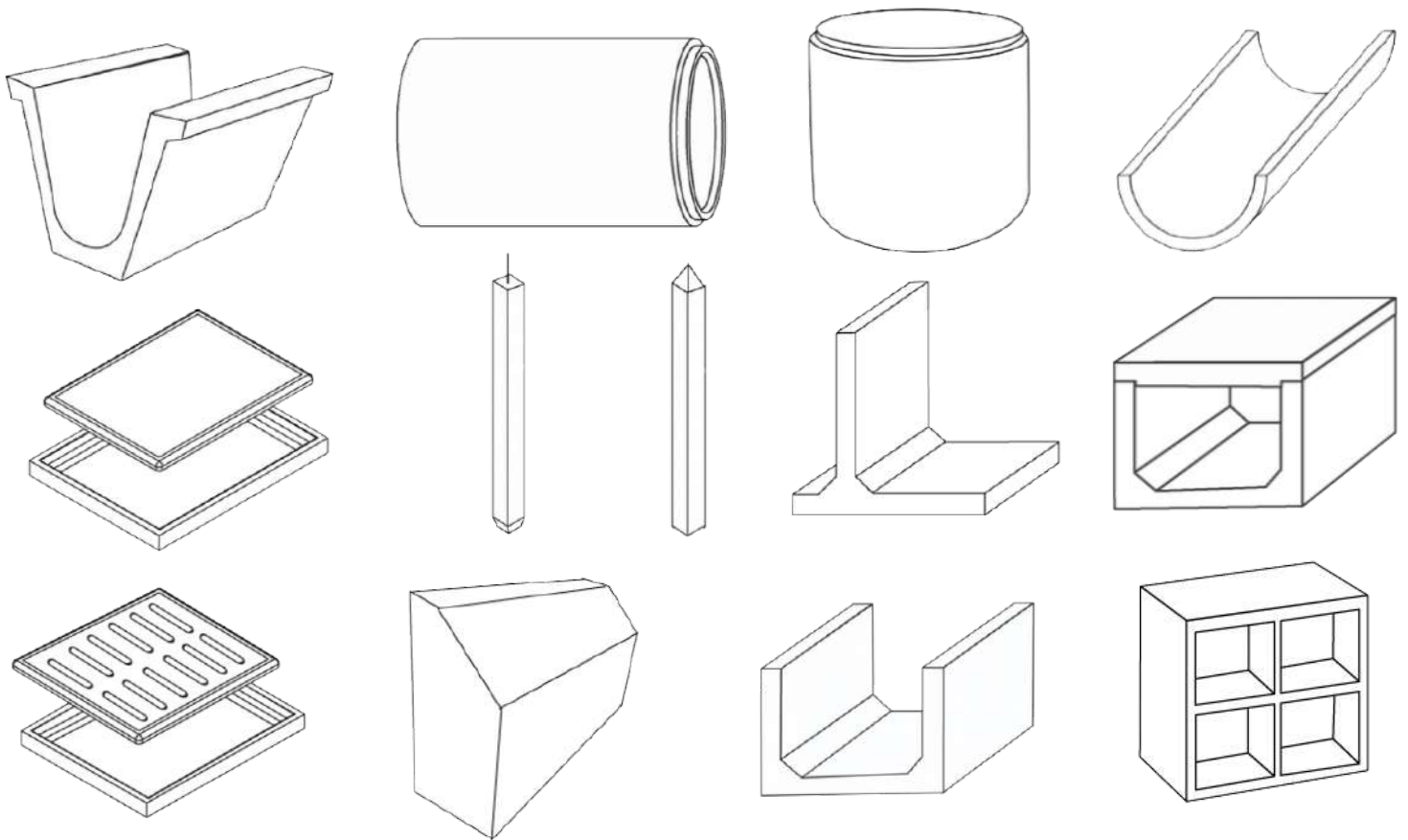



CONCRETE

LT CONCRETE SDN BHD

201901037255 (1346585-V)

SOLID CONCRETE, SOLID COMMITMENT

TABLE OF CONTENTS

01	ABOUT US	
02	U DRAIN (WITH OR W/O DWF)	
03	BOX CULVERT	
04	SPUN PIPE/ PRECAST CONCRETE PIPE CULVERT	
	<ul style="list-style-type: none">• WITH REBATED JOINT - CLASS X• WITHOUT JOINT TYPE S	
05	L SHAPE WALL PRECAST HALF ROUND DRAIN	
06	BLOCK DRAIN	
07	REINFORCEMENT CONCRETE PILE (RC PILE)	
08	CULVERT	
	<ul style="list-style-type: none">• CULVERT (PEMBENTUNG)• CULVERT FLOOR (PEMBENTUNG LANTAI)• CULVERT COVER (PENUTUP PEMBENTUNG)	
09-10	PRECAST RC POLE	
	<ul style="list-style-type: none">• PRE-STRESS RC COLUMN (TIANG SIMEN)• PRE-STRESS RC POLE (TIANG PAGAR)• PRE-STRESS RC POLE SUPPORT (TIANG SOKONG)• PRE-STRESS RC POLE DRAGON (TIANG NAGA)• REINFORCED CONCRETE SLAB	  
11	IBS CONCRETE WALL ROAD CURVE	
12-14	REINFORCED CONCRETE DRAIN COVER & FRAME	
14-16	REINFORCED CONCRETE HEAVY DUTY MANHOLE COVER & FRAME	
17	VENTILATION BLOCK (BATU BUNGA)	



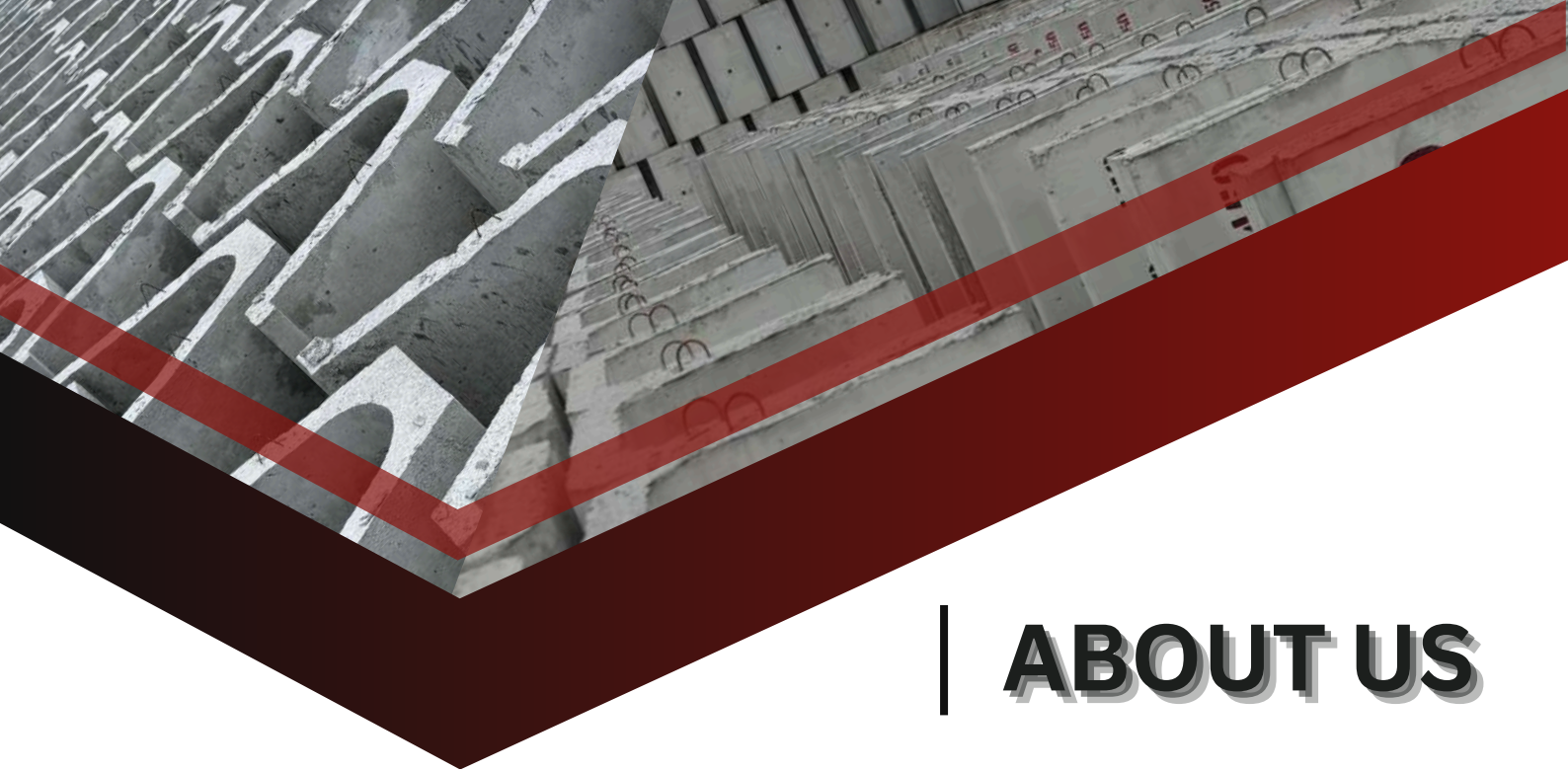

ABOUT US

LT Concrete is a trusted leader in the production and supply of high-quality concrete products. Specializing in the manufacturing of durable and reliable concrete items, we offer a wide range of products including U-drains, spun pipe, RC piles, and other concrete solutions, tailored to meet the needs of construction and infrastructure projects.

Dedicated to quality, innovation, and customer satisfaction, LT Concrete supports the growth and development of the communities we serve. Whether you're building, repairing, or expanding, LT Concrete is here to provide the materials you need for lasting success.

OUR COMMITMENT



1. Produce high quality products

Deliver durable, strong, and reliable concrete products that meet the highest standards.



2. Enhance Technology Improvement

Continuously improve our production processes and invest in R&D to develop new, sustainable concrete solutions.



3. Offer One Stop Service

Provide customer service from production to delivery, ensure customer satisfaction and long-term relationships.

SOLID CONCRETE, SOLID COMMITMENT



U DRAIN W/O DWF

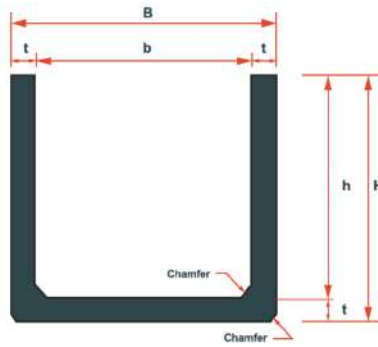

U DRAIN W DWF

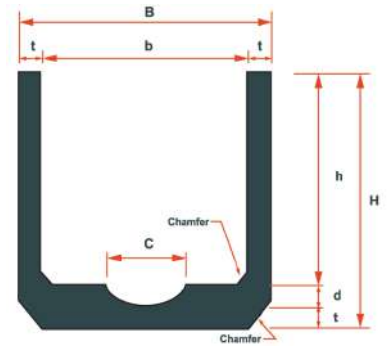

*STANDARD LENGTH ONE (1) METRE.

STANDARD DIMENSION

Nominal Size		Without DWF					With DWF			
Size mm	b mm	h mm	t mm	B mm	H mm	Weight (tonnes)	H mm	C mm	d mm	Weight (tonnes)
300 x 300	300	300	60	420	360	0.13	420	180	60	0.16
375 x 375	375	375	60	495	435	0.17	495	185	60	0.22
450 x 300	450	300	65	580	365	0.19	435	240	70	0.25
450 x 450	450	450	65	580	515	0.22	585	240	70	0.28
600 x 300	600	300	70	740	370	0.23	440	300	70	0.35
600 x 450	600	450	70	740	520	0.28	590	300	70	0.40
600 x 600	600	600	70	740	670	0.34	740	300	70	0.43
750 x 450	750	450	80	910	530	0.31	615	370	85	0.51
750 x 600	750	600	80	910	680	0.37	765	370	85	0.55
750 x 750	750	750	80	910	830	0.46	915	370	85	0.58
900 x 450	900	450	90	1080	540	0.38	625	445	85	0.47
900 x 600	900	600	90	1080	690	0.45	775	445	85	0.54
900 x 750	900	750	90	1080	840	0.52	925	445	85	0.61
900 x 900	900	900	90	1080	990	0.63	1075	445	85	0.68
1200 x 600	1200	600	100	1400	700	0.65	925	1000	225	0.99
1200 x 750	1200	750	100	1400	850	0.69	1075	1000	225	1.06
1200 x 900	1200	900	100	1400	1000	0.76	1225	1000	225	1.10
1200 x 1050	1200	1050	100	1400	1150	0.83	1375	1000	225	1.13
1200 x 1200	1200	1200	100	1400	1300	0.87	1525	1000	225	1.15
1500 x 750	1500	750	105	1710	855	0.78	1080	1000	225	1.30
1500 x 900	1500	900	105	1710	1005	0.86	1230	1000	225	1.38
1500 x 1050	1500	1050	105	1710	1155	0.94	1380	1000	225	1.46
1500 x 1200	1500	1200	105	1710	1305	1.02	1530	1000	225	1.54
1500 x 1350	1500	1350	105	1710	1455	1.10	1680	1000	225	1.62
1500 x 1500	1500	1500	105	1710	1605	1.19	1830	1000	225	1.72
1800 x 900	1800	900	120	2040	1020	1.06	1245	1000	225	1.86
1800 x 1050	1800	1050	120	2040	1170	1.15	1395	1000	225	1.95
1800 x 1200	1800	1200	120	2040	1320	1.24	1545	1000	225	2.04
1800 x 1350	1800	1350	120	2040	1470	1.33	1695	1000	225	2.13
1800 x 1500	1800	1500	120	2040	1620	1.42	1845	1000	225	2.22
1800 x 1650	1800	1650	120	2040	1770	1.51	1995	1000	225	2.30
1800 x 1800	1800	1800	120	2040	1920	1.62	2145	1000	225	2.33
2100 x 2100	2100	2100	165	2390	2245	2.48	2715	1000	225	3.22

*The above measurements are based on standard measuring methods. Actual sizes may vary slightly.

*Our company reserves the right to modify the above sizes without prior notice.



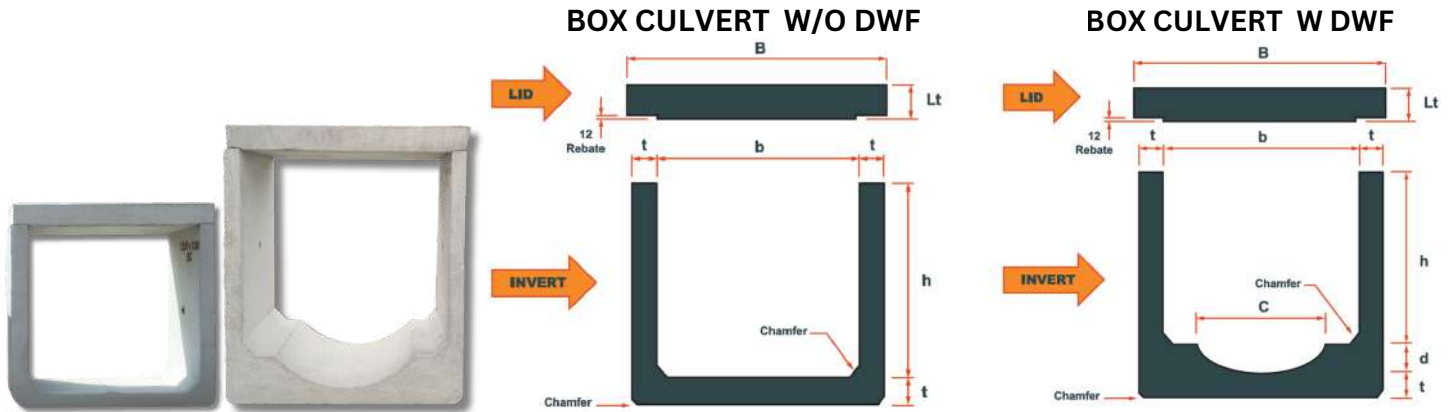

*STANDARD LENGTH ONE (1) METRE.

STANDARD DIMENSION

Norminal Size								Weight (Tonnes)		
Size mm	b mm	h mm	t mm	C mm	d mm	B mm	Lt mm	LID	Invert (w/o DWF)	Invert (c/w DWF)
300 x 300	300	300	60	180	60	420	125	0.126	0.19	0.19
375 x 375	375	375	60	185	60	495	125	0.149	0.19	0.24
450 x 300	450	300	65	240	70	580	125	0.174	0.24	0.26
450 x 450	450	450	65	240	70	580	125	0.174	0.29	0.31
600 x 300	600	300	70	300	70	740	140	0.252	0.28	0.35
600 x 450	600	450	70	300	70	740	140	0.252	0.31	0.40
600 x 600	600	600	70	300	70	740	140	0.252	0.35	0.45
750 x 450	750	450	80	370	85	910	140	0.302	0.37	0.51
750 x 600	750	600	80	370	85	910	140	0.302	0.43	0.57
750 x 750	750	750	80	370	85	910	140	0.302	0.48	0.63
900 x 450	900	450	90	445	85	1080	150	0.388	0.45	0.47
900 x 600	900	600	90	445	85	1080	150	0.388	0.52	0.54
900 x 750	900	750	90	445	85	1080	150	0.388	0.59	0.61
900 x 900	900	900	90	445	85	1080	150	0.388	0.62	0.68
1200 x 600	1200	600	100	1000	225	1400	150	0.504	0.69	0.99
1200 x 750	1200	750	100	1000	225	1400	150	0.504	0.76	1.06
1200 x 900	1200	900	100	1000	225	1400	150	0.504	0.83	1.13
1200 x 1050	1200	1050	100	1000	225	1400	150	0.504	0.88	1.20
1200 x 1200	1200	1200	100	1000	225	1400	150	0.504	0.93	1.27
1500 x 750	1500	750	105	1000	225	1710	180	0.803	0.86	1.30
1500 x 900	1500	900	105	1000	225	1710	180	0.803	0.94	1.38
1500 x 1050	1500	1050	105	1000	225	1710	180	0.803	1.02	1.46
1500 x 1200	1500	1200	105	1000	225	1710	180	0.803	1.10	1.54
1500 x 1350	1500	1350	105	1000	225	1710	180	0.803	1.18	1.62
1500 x 1500	1500	1500	105	1000	225	1710	180	0.803	1.24	1.70
1800 x 900	1800	900	120	1000	225	2040	210	1.118	1.15	1.86
1800 x 1050	1800	1050	120	1000	225	2040	210	1.118	1.24	1.95
1800 x 1200	1800	1200	120	1000	225	2040	210	1.118	1.33	2.04
1800 x 1350	1800	1350	120	1000	225	2040	210	1.118	1.42	2.13
1800 x 1500	1800	1500	120	1000	225	2040	210	1.118	1.51	2.22
1800 x 1650	1800	1650	120	1000	225	2040	210	1.118	1.57	2.31
1800 x 1800	1800	1800	120	1000	225	2040	210	1.118	1.62	2.40
2100 x 2100	2100	2100	165	1000	225	2430	240	1.27	2.48	3.22

*The above measurements are based on standard measuring methods. Actual sizes may vary slightly.
 *Our company reserves the right to modify the above sizes without prior notice.



PRECAST CONCRETE PIPE CULVERT WITH REBATED JOINT - CLASS X

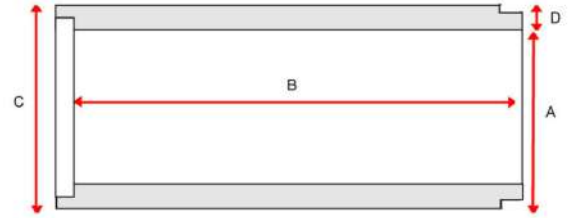

STANDARD DIMENSION

	Nominal Diameter		Length B mm	A mm	C mm	D mm	Approx. Weight mt
	mm	in					
1" X 5"	300	12	1520	340	360	20	0.11
1 ¼" X 5"	375	15	1520	375	445	35	0.15
1½" X 5"	450	18	1520	450	530	40	0.24
2" X 5"	600	24	1520	600	700	50	0.4
2½" X 5"	750	30	1520	750	860	55	0.55
3" X 5"	900	36	1520	900	1030	65	0.78
4" X 5"	1200	48	1520	1200	1370	85	1.35
5" X 5"	1500	60	1520	1500	1710	105	2.08



PRECAST CONCRETE PIPE CULVERT WITHOUT JOINT - TYPE S

STANDARD DIMENSION

	Nominal Diameter		Length B mm	A mm	C mm	D mm	Approx. Weight mt
	mm	in					
1" X 5"	300	12	1520	300	370	35	0.13
1 ¼" X 5"	375	15	1520	375	445	35	0.16
1½" X 5"	450	18	1520	450	530	40	0.23
2" X 5"	600	24	1520	600	700	50	0.33
2½" X 5"	750	30	1520	750	860	55	0.43
3" X 5"	900	36	1520	900	1020	60	0.57
4" X 5"	1200	48	1520	1200	1350	75	1.00
5" X 5"	1500	60	1520	1500	1670	85	1.35

Constituent Materials

Cement	MX 522 Ordinary Portland Cement
Steel Reinforcement	BS 449 / MS 146
Aggregates	BS 882 / MS 29 Mining Sand / 20mm Aggregates
Admixture	BS 5075 / MS 922 Super Plasticizer
Cold Drawn Wire	BS 4482 / MS 144 Lateral Reinforcement Stirrup
Mild Steel Plate	BS EN 10137-1 End Plate (Grade 43A)

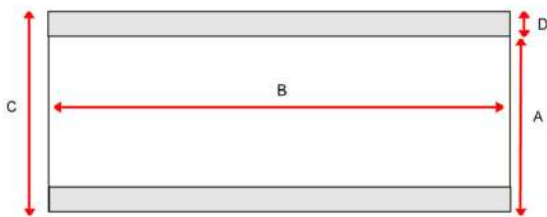

*The above measurements are based on standard measuring methods. Actual sizes may vary slightly.
 *Our company reserves the right to modify the above sizes without prior notice.



L SHAPE WALL

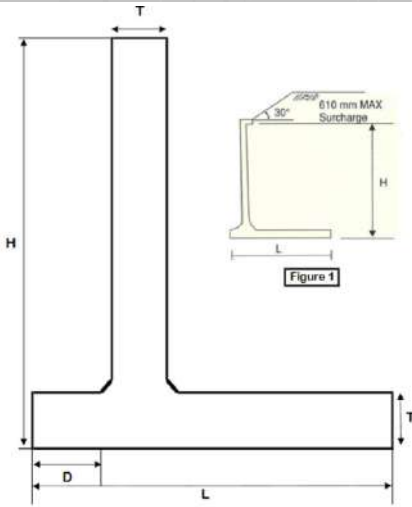

Design Criteria accordance with the following condition:

- Minimum Concrete Grade 35 N/mm²
- Bulk Density of soil backfill 17.30 kN/m³
- Surcharge of 610mm maximum with 30° slope (Figure 1)
- Angle of internal friction of soil backfill to be 30°

Product Advantages:

- Easily to install and dismantle
- Reliable quality control with factory manufacture condition
- Maintenance free
- Enable off loaded from transportation
- Easily assemble by unskilled labour

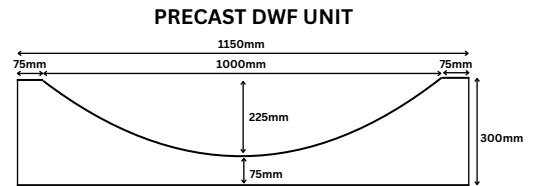

STANDARD DIMENSION

H mm	L mm	D mm	T mm	Weight(±) tonne
1200	1100	150	100	0.55
1800	1550	250	150	1.10
1950	2100	300	150	1.30
3200	2450	450	200	2.70

* Standard length = 1000mm

HALF ROUND DRAIN

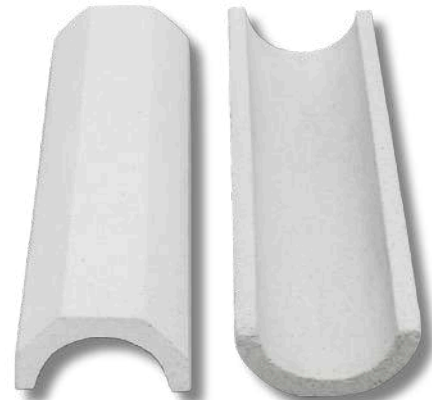
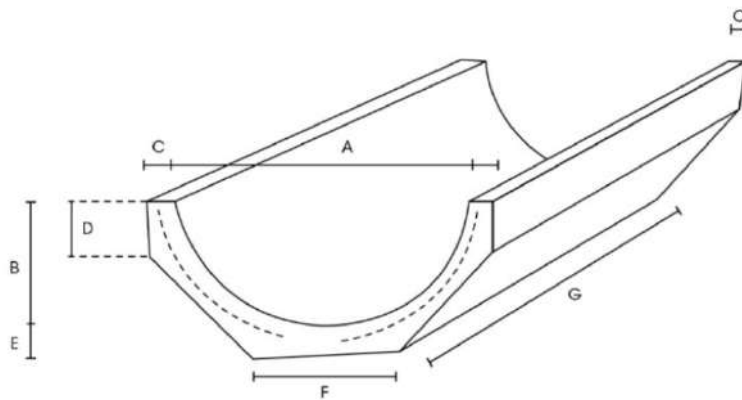

STANDARD DIMENSION

Norminal Size (mm)	A	B	C	D	E	F	G	kg
6"	150 x 750	150	137.5	25	50	25	87.5	12.5
9"	225 x 750	225	150	25	62.5	25	115	20
12"	300 x 600	300	175	35	80	35	125	26.5



*The above measurements are based on standard measuring methods. Actual sizes may vary slightly.
*Our company reserves the right to modify the above sizes without prior notice.



PRECAST CONCRETE BLOCK DRAINS (ORDINARY) LONGKANG V BIASA

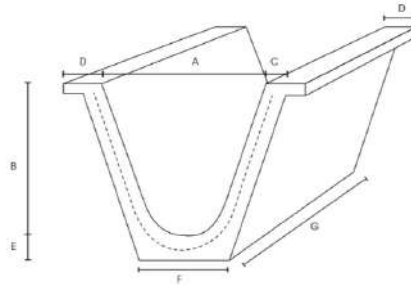
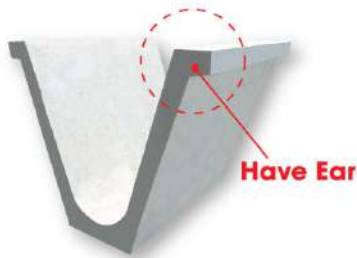

STANDARD DIMENSION

	Norminal Size (mm)	A	B	C	D	E	F	G	kg
12"	300 x 600	300	300	25	37.5	50	175	600	50
15"	375 x 600	375	375	25	37.5	50	175	600	65
18"	450 x 600	450	450	25	37.5	75	225	600	85
24"	600 x 600	600	600	55	87.5	75	225	600	135

PRECAST CONCRETE BLOCK DRAINS JKR "V" LONGKANG "V" JKR

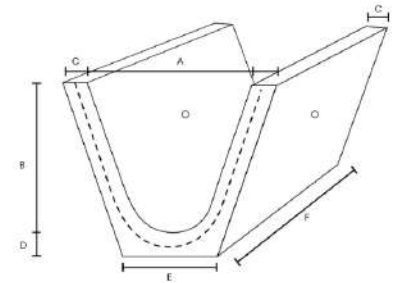

STANDARD DIMENSION

	Norminal Size (mm)	A	B	C	D	E	F	kg
12"	300 x 600	300	300	65	75	180	600	76
15"	375 x 600	375	375	75	90	240	600	110
18"	450 x 600	450	450	75	90	300	600	125
24"	600 x 600	600	600	75	100	355	600	180

PRECAST CONCRETE BLOCK DRAINS JKR "U" LONGKANG "U" JKR

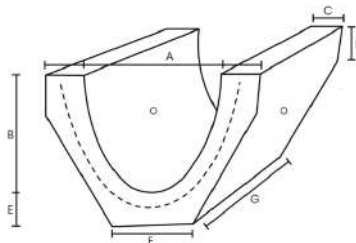

STANDARD DIMENSION

	Norminal Size (mm)	A	B	C	D	E	F	G	kg
15"	375 x 600	375	375	75	100	75	250	600	80
18"	450 x 600	450	450	75	100	75	280	600	110
24"	600 x 800	600	600	100	125	100	362.5	600	170



*The above measurements are based on standard measuring methods. Actual sizes may vary slightly.
*Our company reserves the right to modify the above sizes without prior notice.



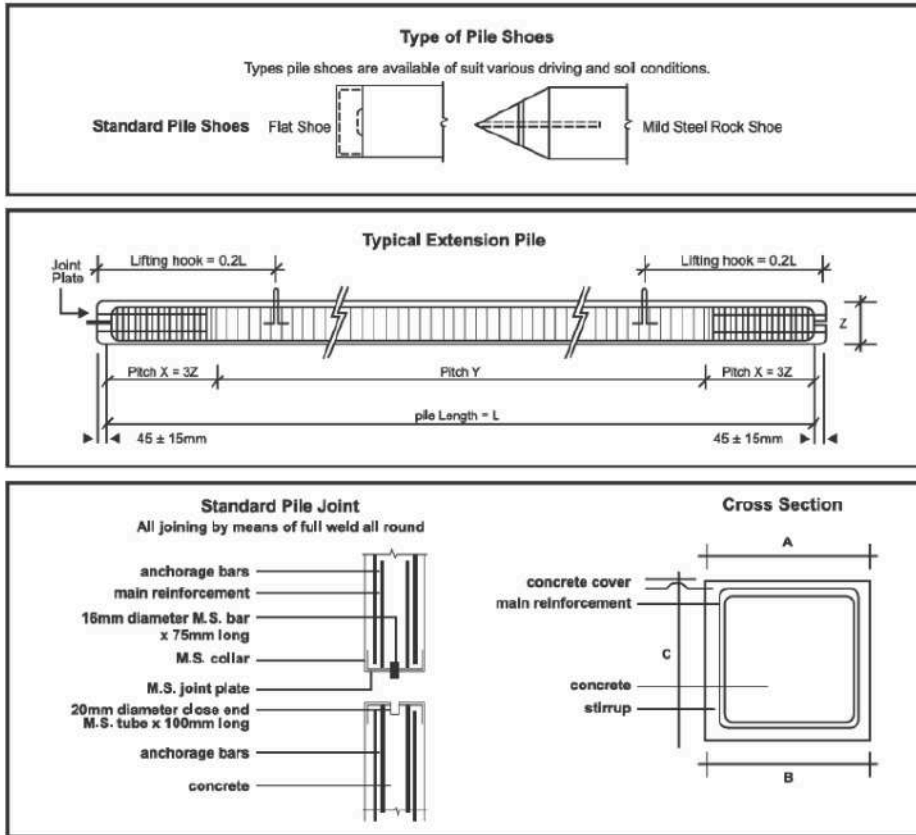

Constituent Materials	
Cement	MS 522 ordinary portland cement
Steel Reinforcement	BS 4449 / MS 146
Aggregates	BS 882 / MS 29 mining sand / 20mm aggregates
Admixture	BS 5075 / MS 922 super plasticizer
Cold Drawn Wire	BS 4482 / MS 144 lateral reinforcement stirrup
Mild Steel Plate	BS EN 10137-1 end plate (Grade 43A)

STANDARD DIMENSION

Dimension					Main Reinforcement Bar nos x dia mm	Wire Rods			Plate Thickness mm	Concrete Cover mm	Axial Load Capacity	
Size mm	Length m	A mm	B mm	C mm		Wire Diameter mm	Stirrups				Max Safe Structural Working Load (tonnes)	Recommended Working Load (tonnes)
							Pitch X mm	Pitch Y mm				
150 X 150	6 , 3	153	147	150	4 X T9	4.5	40	90	4.5	30	35	28
200 X 200	6 , 3	203	197	200	4 X T10	4.5	35	100	6	30	61	48
200 X 200	6 , 3	203	197	200	4 X T12	4.5	35	100	6	30	61	48

TECHINICAL CALCULATIONS

Capacity of RC Piles in accodance to standard specified.
 Safe working load = 0.275f_{cu} *AC + f_{sc} *AS

where,
 f_{cu} = characteristic strenght of concrete at 28 days (45N/mm)
 AC = area of concrete
 AS = area of main reinforcement
 f_{sc} = 175N/mm for high yield steel

* The acial load capacities are based on the structural capacities of RC pile and actual pile bearing capacities may need to consider the geotechnical factor.



*The above measurements are based on standard measuring methods. Actual sizes may vary slightly.
 *Our company reserves the right to modify the above sizes without prior notice.



CULVERT (PEMBENTUNG)

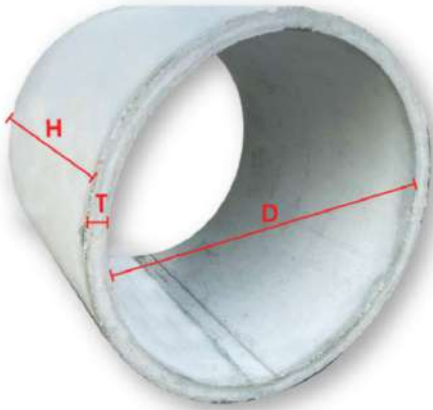

STANDARD DIMENSION

Diameter (D)		Height (H)		Thickness (T)	Weight
feet	mm	feet	mm	mm	kg
3'	900	3'	900	60	330
3'	900	2'	600	60	210
3'	900	4'	1200	60	505
3'	1200	3'	900	60	510

CULVERT FLOOR (PEMBENTUNG LANTAI)

STANDARD DIMENSION

Diameter (D)		Height (H)		Thickness (T)	Weight
feet	mm	feet	mm	mm	kg
3'	900	3'	900	60	410
4'	1290	3'	900	60	720



CULVERT COVER (PENUTUP PEMBENTUNG)

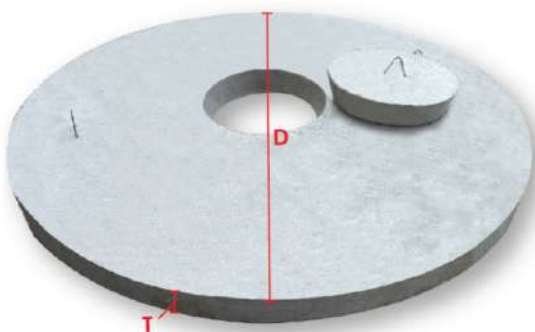

STANDARD DIMENSION

Diameter (D)		Thickness (T)	Weight
feet	mm	mm	kg
3'	90	50	90



*The above measurements are based on standard measuring methods. Actual sizes may vary slightly.
 *Our company reserves the right to modify the above sizes without prior notice.



PRE-STRESSED RC COLUMN (TIANG SIMEN)

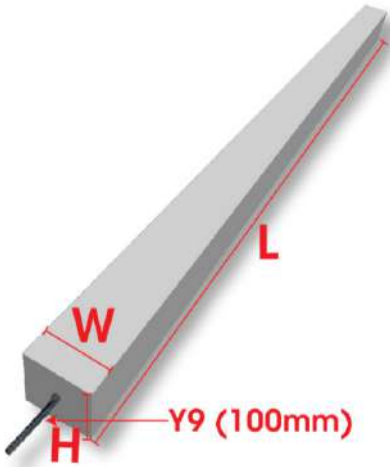

STANDARD DIMENSION

Width (W)		Height (H)		Length (L)		Weight
inch	mm	inch	mm	feet	mm	kg
4"	100	4"	100	7'	2100	52.50
4"	100	4"	100	8'	2400	60.00
4"	100	4"	100	9'	2700	67.50
4"	100	4"	100	10'	3000	75.00
4"	100	4"	100	11'	3300	82.50
4"	100	4"	100	12'	3600	90.00

PRE-STRESSED RC POLE (TIANG PAGAR)

STANDARD DIMENSION

Width (W)		Height (H)		Length (L)		Weight
inch	mm	inch	mm	feet	mm	kg
3"	75	3"	75	6'	1800	27
3"	75	3"	75	6.5'	1990	29
4"	100	4"	100	6.5'	1980	43
4"	100	4"	100	7'	2140	49

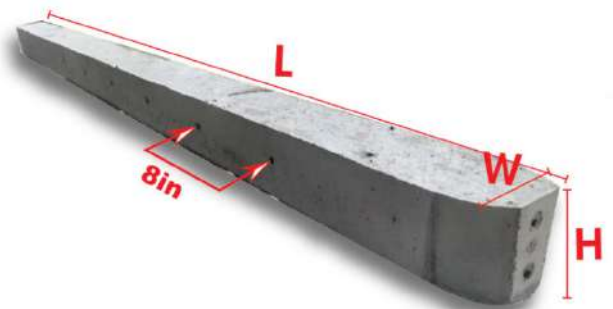

*The above measurements are based on standard measuring methods. Actual sizes may vary slightly.
 *Our company reserves the right to modify the above sizes without prior notice.



PRE-STRESSED RC POLE SUPPORT (TIANG SOKONG)

STANDARD DIMENSION

Width (W)		Height (H)		Length (L)		Weight
inch	mm	inch	mm	feet	mm	kg
3"	75	3"	75	6'	1800	27
3"	75	4"	100	6'	1800	34



PRE-STRESSED RC POLE DRAGON (TIANG NAGA)

STANDARD DIMENSION

Width (W)		Height (H)		Length (L)		Weight
inch	mm	inch	mm	feet	mm	kg
3"	75	3"	75	5'	1500	24
3"	75	3"	75	5.5'	1650	26
3"	75	3"	75	6'	1800	29
3"	75	3"	75	6.5'	1950	31
3"	75	3"	75	7'	2100	33

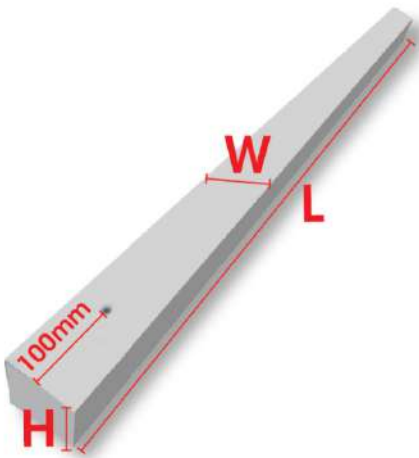

REINFORCED CONCRETE SLAB

STANDARD DIMENSION

Product Code	Length (A) mm	Width (B) mm	Cover		Weight kg
			Thickness (C) mm		
CS1890	1890	490	55		122

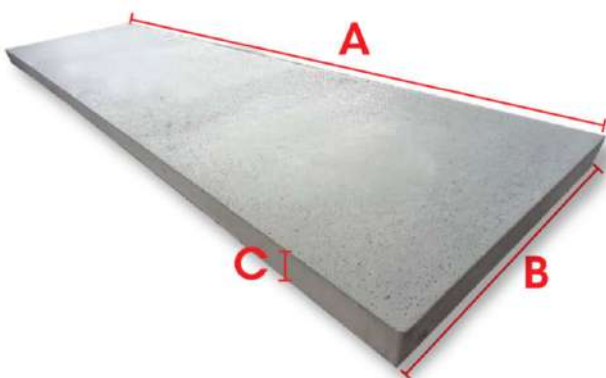

*The above measurements are based on standard measuring methods. Actual sizes may vary slightly.

*Our company reserves the right to modify the above sizes without prior notice.



IBS CONCRETE WALL



STANDARD DIMENSION

Length mm	Height mm	Width mm
2430	2040	50

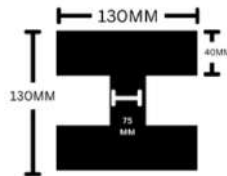

IBS CONCRETE WALL SLAB

STANDARD DIMENSION

Length mm	Height mm	Width mm
2430	510	50

IBS CONCRETE WALL PILES

STANDARD DIMENSION

Length mm	Height mm	Width mm
3370	130	130

ROAD CURVE

ROAD CURVE C/W HOLE

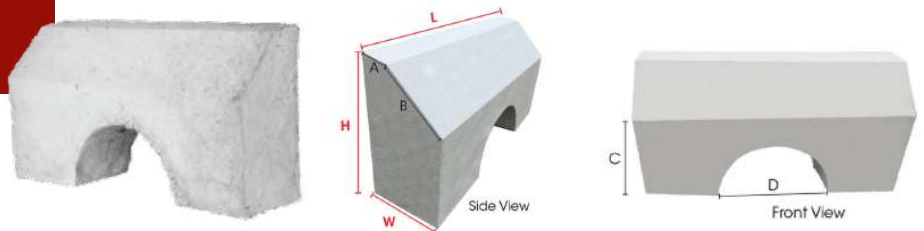

STANDARD DIMENSION

Width (W) mm	Height (H) mm	Length (L) mm	A mm	B mm	C mm	D mm	Weight kg
150	300	600	55	135	205	260	50

ROAD CURVE

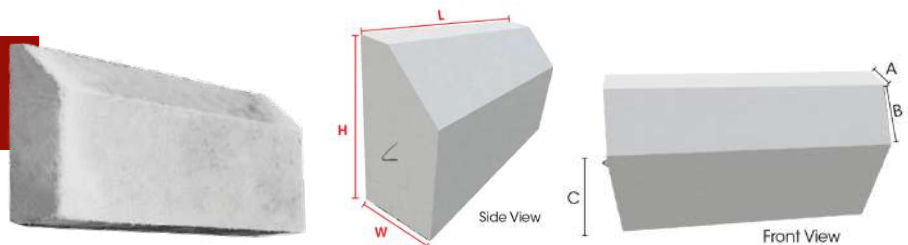

STANDARD DIMENSION

Width (W) mm	Height (H) mm	Length (L) mm	A mm	B mm	C mm	Weight kg
150	300	600	55	135	205	55



*The above measurements are based on standard measuring methods. Actual sizes may vary slightly.
*Our company reserves the right to modify the above sizes without prior notice.



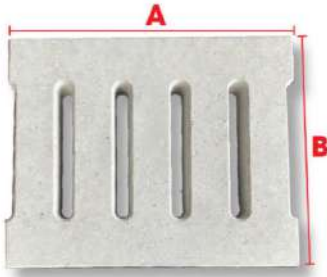

STANDARD DIMENSION

Cover				
Product Code	Length (A) mm	Width (B) mm	Thickness mm	Weight kg
DC6684	600	600	80	52

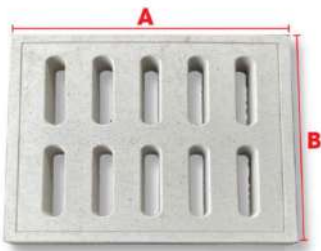

STANDARD DIMENSION

Cover				
Product Code	Length (A) mm	Width (B) mm	Thickness mm	Weight kg
DC66510	600	600	50	31

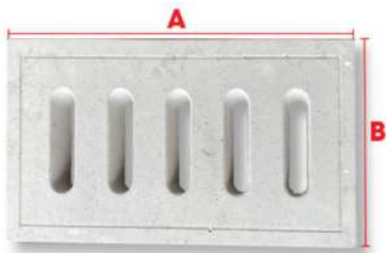

STANDARD DIMENSION

Cover				
Product Code	Length (A) mm	Width (B) mm	Thickness mm	Weight kg
DC6355	600	300	50	16

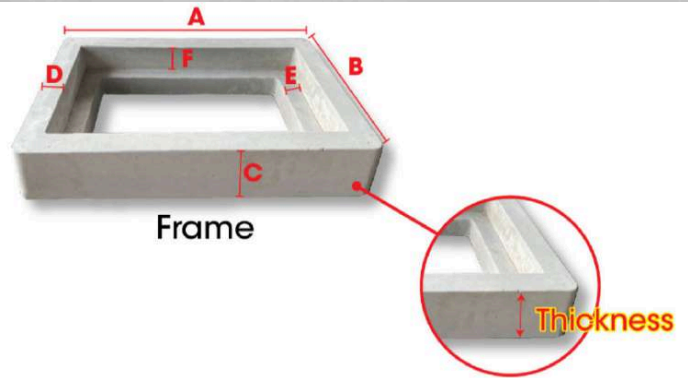
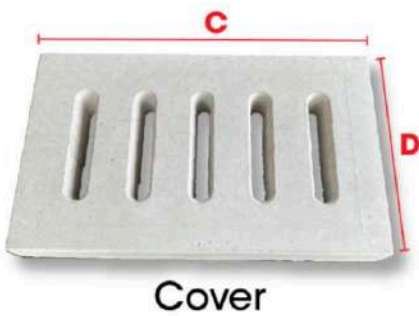

STANDARD DIMENSION

Cover				
Product Code	Length (C) mm	Width (D) mm	Thickness mm	Weight kg
DC5365	500	300	60	18

Frame							
Product Code	A mm	B mm	C mm	D mm	E mm	F mm	Weight kg
CF5365	600	400	100	45	40	60	29

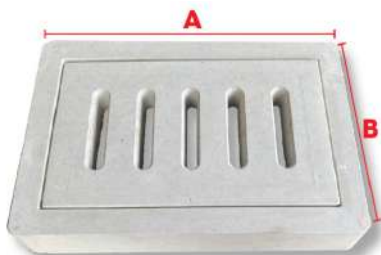

Combined

STANDARD DIMENSION

Combined				
Product Code	Length (A) mm	Width (B) mm	Thickness mm	Weight kg
DCF5365	600	400	100	47



*The above measurements are based on standard measuring methods. Actual sizes may vary slightly.
*Our company reserves the right to modify the above sizes without prior notice.

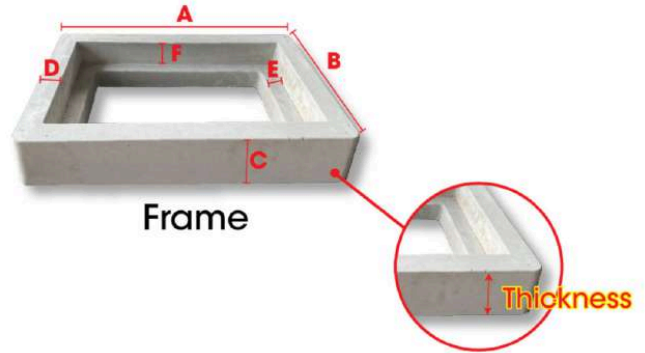
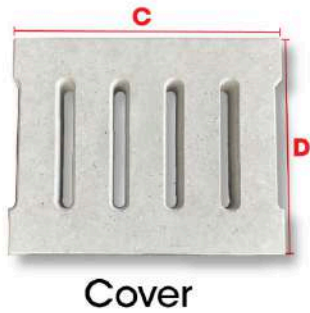

STANDARD DIMENSION

Cover				
Product Code	Length (C) mm	Width (D) mm	Thickness mm	Weight kg
DC5464	500	400	60	23

Frame							
Product Code	A mm	B mm	C mm	D mm	E mm	F mm	Weight kg
CF5464	600	500	100	45	35	50	35

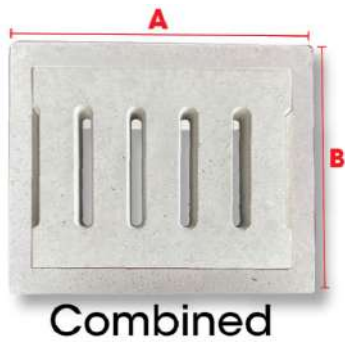

STANDARD DIMENSION

Combined				
Product Code	Length (A) mm	Width (B) mm	Thickness mm	Weight kg
DCF5464	600	500	100	58

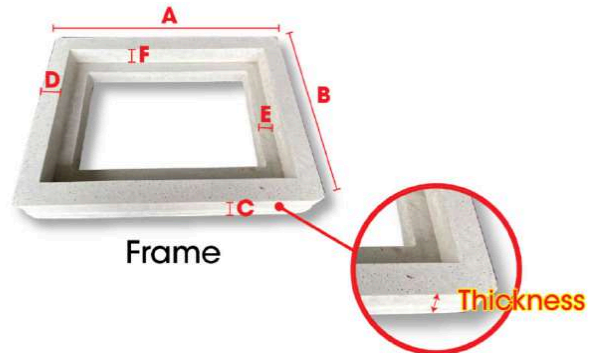
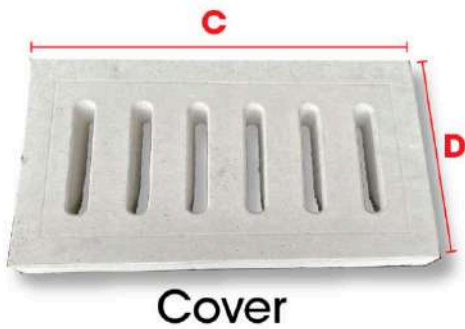

STANDARD DIMENSION

Cover				
Product Code	Length (C) mm	Width (D) mm	Thickness mm	Weight kg
DC6466	600	400	60	27

Frame							
Product Code	A mm	B mm	C mm	D mm	E mm	F mm	Weight kg
CF6466	700	500	100	50	40	60	41

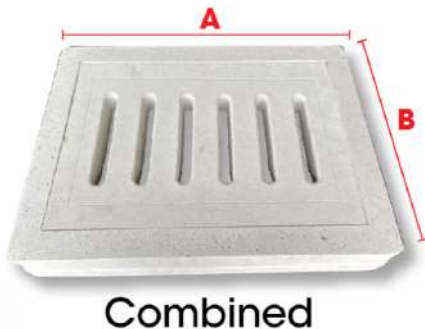

STANDARD DIMENSION

Combined				
Product Code	Length (A) mm	Width (B) mm	Thickness mm	Weight kg
DCF6466	700	500	100	68



*The above measurements are based on standard measuring methods. Actual sizes may vary slightly.
 *Our company reserves the right to modify the above sizes without prior notice.



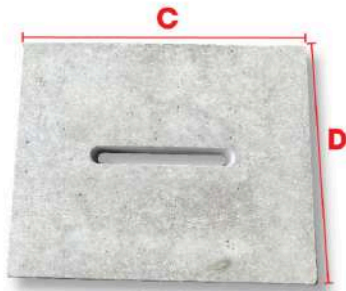

Cover

STANDARD DIMENSION

Cover				
Product Code	Length (C) mm	Width (D) mm	Thickness mm	Weight kg
DC5461	500	400	60	26

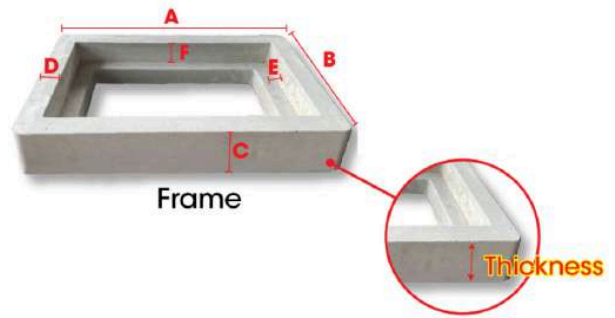

Frame

Frame							
Product Code	A mm	B mm	C mm	D mm	E mm	F mm	Weight kg
CF5461	600	500	100	45	35	50	35

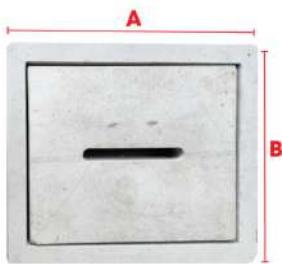

Combined

STANDARD DIMENSION

Combined				
Product Code	Length (A) mm	Width (B) mm	Thickness mm	Weight kg
DCF5461	600	500	100	61

REINFORCED CONCRETE MANHOLE COVER & FRAME

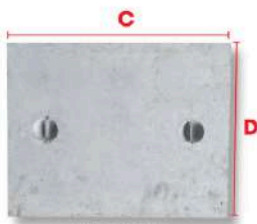

Cover

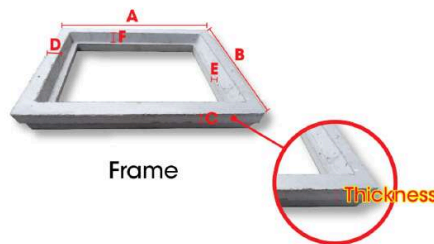

Frame

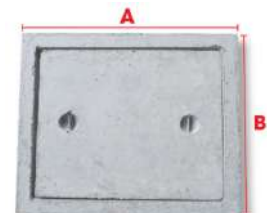

Combined

SET: 31.7kg

STANDARD DIMENSION

Cover				
Product Code	Length (C) mm	Width (D) mm	Thickness mm	Weight kg
M1824C	530	430	40	15.3

Frame							
Product Code	A mm	B mm	C mm	D mm	E mm	F mm	Weight kg
M1824C	630	530	80	50	20	40	16.4

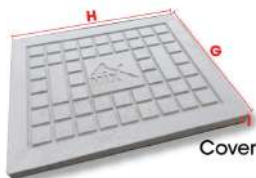

Cover

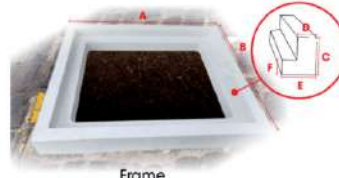

Frame



SET: 25kg

STANDARD DIMENSION

Cover				
Product Code	G mm	H mm	I mm	Weight kg
MC1824A	400	500	30	11

Frame							
Product Code	A mm	B mm	C mm	D mm	E mm	F mm	Weight kg
MC1824A	570	470	70	30	70	40	14



*The above measurements are based on standard measuring methods. Actual sizes may vary slightly.
*Our company reserves the right to modify the above sizes without prior notice.

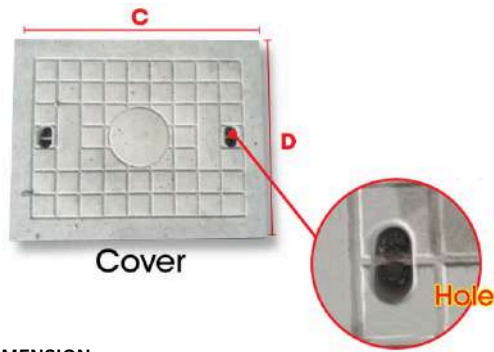

Cover

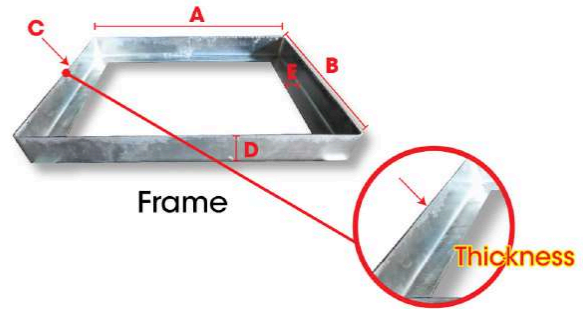

Frame

STANDARD DIMENSION

Cover				
Product Code	Length (C) mm	Width (D) mm	Thickness mm	Weight kg
MC5560	500	500	60	32

Frame						
Product Code	A mm	B mm	C mm	D mm	E mm	Weight kg
SF5560	510	510	2.5	60	30	3.6

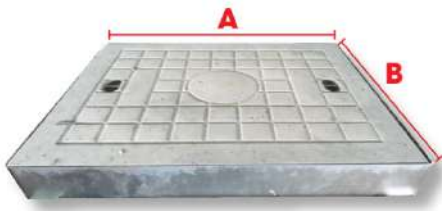

Combined

STANDARD DIMENSION

Combined				
Product Code	Length (A) mm	Width (B) mm	Thickness mm	Weight kg
MCSF5560	510	510	60	35.6

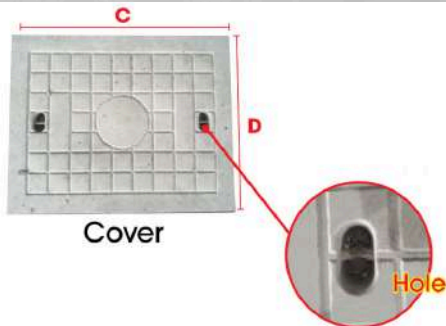

Cover

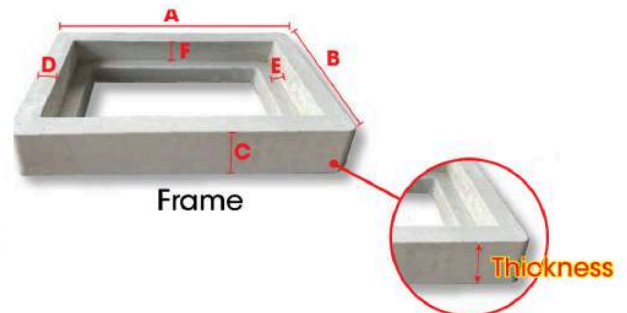

Frame

STANDARD DIMENSION

Cover				
Product Code	Length (C) mm	Width (D) mm	Thickness mm	Weight kg
MC5560	500	500	60	32

Frame							
Product Code	A mm	B mm	C mm	D mm	E mm	F mm	Weight kg
CF5560	600	600	100	50	40	60	38

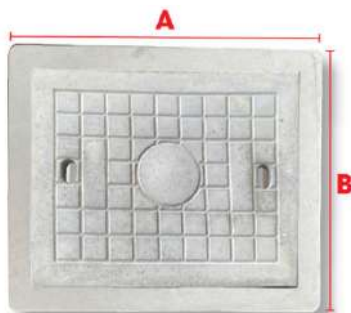

Combined

STANDARD DIMENSION

Combined				
Product Code	Length (A) mm	Width (B) mm	Thickness mm	Weight kg
MCF5560	600	600	100	70



*The above measurements are based on standard measuring methods. Actual sizes may vary slightly.
*Our company reserves the right to modify the above sizes without prior notice.

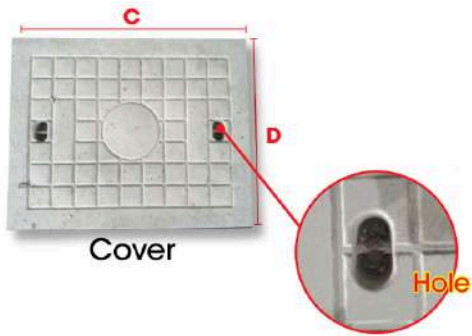

Cover

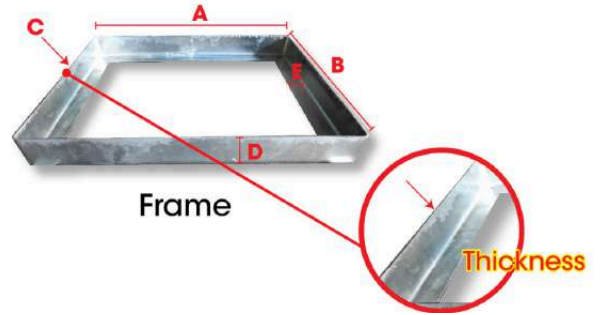

Frame

STANDARD DIMENSION

Cover				
Product Code	Length (C) mm	Width (D) mm	Thickness mm	Weight kg
MC5460	500	400	60	27

Frame						
Product Code	A mm	B mm	C mm	D mm	E mm	Weight kg
SF5460	510	410	2.5	60	30	3.4

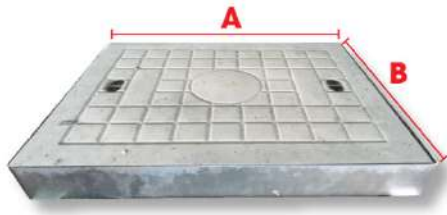

Combined

STANDARD DIMENSION

Combined				
Product Code	Length (A) mm	Width (B) mm	Thickness mm	Weight kg
MCSF5460	510	410	60	30.4

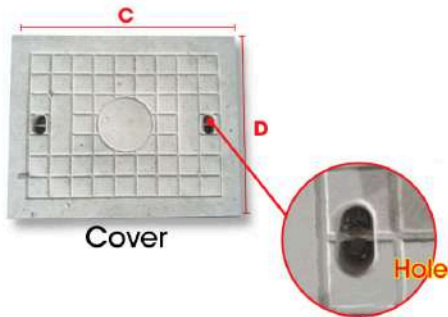

Cover

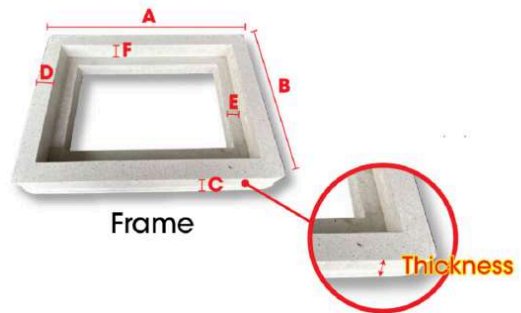

Frame

STANDARD DIMENSION

Cover				
Product Code	Length (C) mm	Width (D) mm	Thickness mm	Weight kg
MC5460	500	400	60	27

Frame							
Product Code	A mm	B mm	C mm	D mm	E mm	F mm	Weight kg
CF5460	600	500	100	45	35	50	35

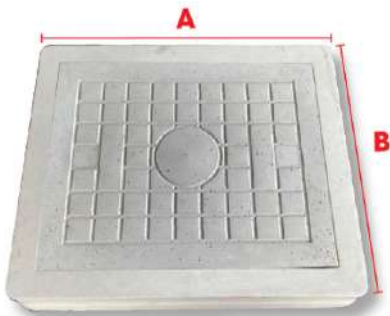

Combined

STANDARD DIMENSION

Combined				
Product Code	Length (A) mm	Width (B) mm	Thickness mm	Weight kg
MCF5560	600	600	100	70



*The above measurements are based on standard measuring methods. Actual sizes may vary slightly.
*Our company reserves the right to modify the above sizes without prior notice.



2 AA 12214



2 CC 12215



2 DD 12215



2 EE 12214



2 EE 12215



2 SB 12214



2 SE 12214

**DESIGN ABOVE WITH TWO FACES*



AA 12214



AA 12215



AA 22216

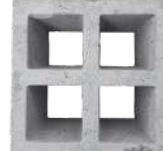

AA 42215

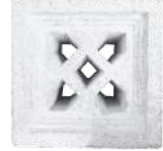

AB 52217



AB 122217



AE 32215



AE 92217



BA 52216



BB 12215



BB 42216



BC 32216



BE 32215



BE 52215



CC 12215



CC 22215



CC 42215



DD 12215



EE 12215



EE 12216



EE 92216

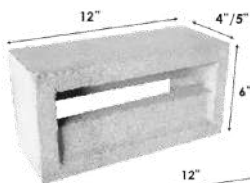

BA4 BA5

4"/5" Batu Angin
Ventilation Block

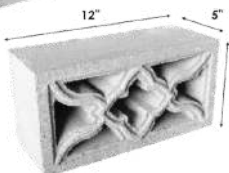

BB5

5" Batu Bunga Islam
Islamic Decoration Block

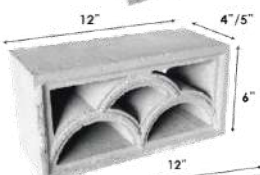

BC5

5" Batu Bunga Mahkota
Rainbow Decoration Block

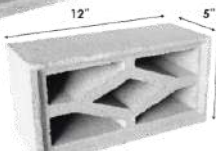

BD5

5" Batu Bunga
Diamond Decoration Block

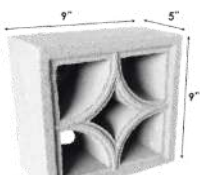

BE9

5" Batu Bunga Permata
Diamond Decoration Block

STANDARD DIMENSION

Length mm	Height mm	Width mm
200	200	100



AA 222412

STANDARD DIMENSION

Length mm	Height mm	Width mm
400	200	200



**The above measurements are based on standard measuring methods. Actual sizes may vary slightly.
Our company reserves the right to modify the above sizes without prior notice.



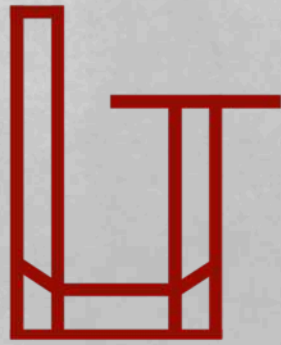

CONCRETE

LT CONCRETE SDN BHD

201901037255 (1346585-V)

SOLID CONCRETE, SOLID COMMITMENT

*Concrete, precast concrete product manufacturer
Building & construction material supplier*



FOLLOW US ON



LTCONCRETE.NS



LTCONCRETE-NS



@ltconcretens6

 LOT 1485, KAMPUNG PARIT TINGGI, 72000 KUALA PILAH, NEGERI SEMBILAN.



+606-481 7736



+606-481 7737



ltconcretens@gmail.com